

# WestLab Audio

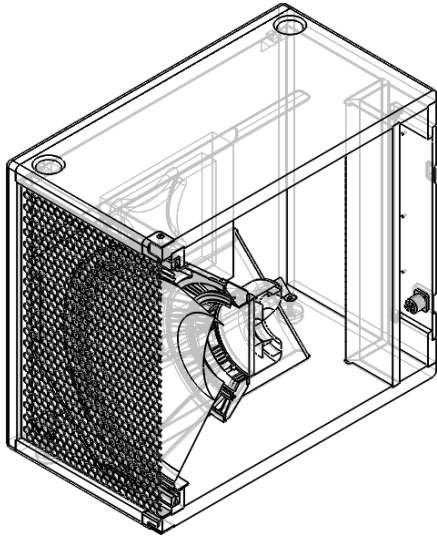

## Product Data

18" Sub

Series: LABSUB

Model: LABSUB 18p (passive)

Dimensions H 544 x W 654 x D 600 mm

Local Box H 565 x W 690 x D 615 mm

Export Box H 620 x W 760 x D 670 mm

Net weight 47 kg

Export boxed 53,5 kg

---

Power Handling (RMS/Program/Peak)

1250/2000/4000 W

Nominal Impedance

8 Ohm

Sensitivity (1W/1m)

102 dB

Max SPL (peak)

134 dB

Frequency Range

28 Hz - 120 Hz

Free Field Frequency Response

30 Hz - 150 Hz

reg. Crossover Frequency

100 Hz

Directivity

Omnidirectional

Cardioid / Hypercardioid in Clusters

driven with Labcon MK2

Low Frequency Driver Chassis type

Cone driver, port loaded

Low Frequency Driver Magnet

Neodymium

Low Frequency Driver Chassis diameter

18" / 458 mm

Low Frequency Driver Voicecoil diameter

4" / 101,6 mm