

WestLab Audio

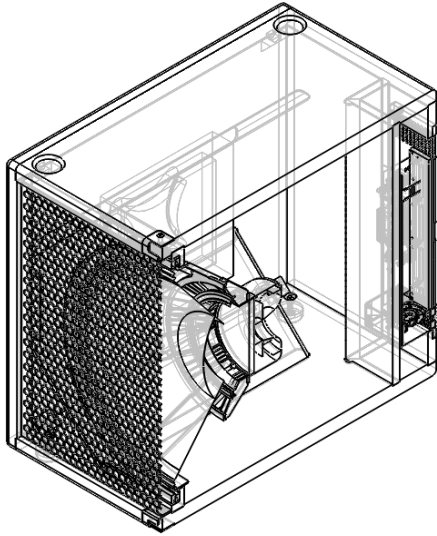

Product Data

18" Sub

Series: LABSUB

Model: LABSUB 18

Dimensions H 544 x W 654 x D 600 mm

Local Box H 565 x W 690 x D 615 mm

Export Box H 620 x W 760 x D 670 mm

Net weight 48 kg

Export boxed 54,5 kg

Total System Power (RMS/Peak)

1550 / 2000 W

Max SPL (peak)

134 dB

Frequency Range

28 Hz - 120 Hz

Free Field Frequency Response

30 Hz - 150 Hz

rec. Crossover Frequency

100 Hz

Directivity

Omnidirectional

Cardioid / Hypercardioid in Clusters

driven with Labcon MK2

Low Frequency Driver Chassis type

Cone driver, port loaded

Low Frequency Driver Magnet

Neodymium

Low Frequency Driver Chassis diameter

18" / 458 mm

Low Frequency Driver Voicecoil diameter

4" / 101,6 mm